

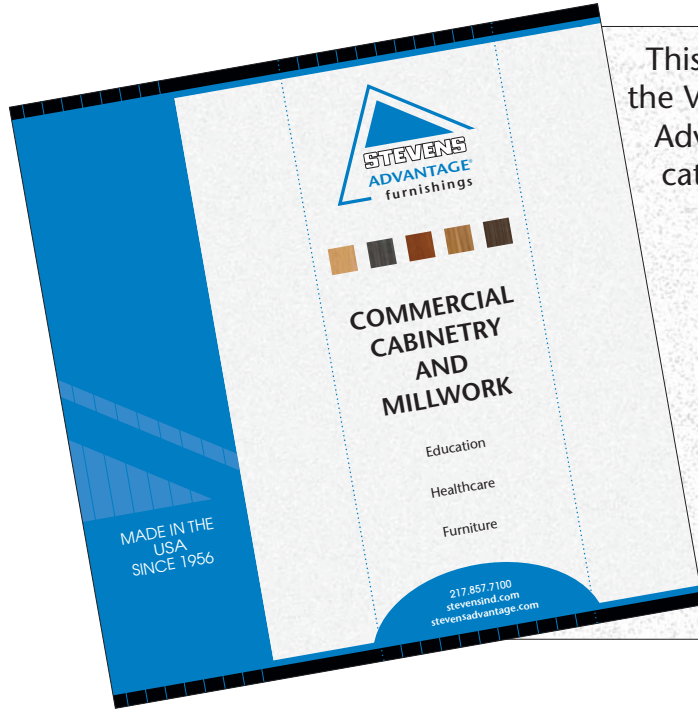

## UPDATE HISTORY

### Valance – Attached Soffit Section



This UPDATE HISTORY outlines changes made to the Valance – Attached Soffit section of the Stevens Advantage Commercial Cabinetry and Millwork catalog since it was published in August 2017.

The most recent updates are shown first.

Go to [stevensadvantage.com](http://stevensadvantage.com)

→ RESOURCES

→ Commercial Casework

to view/download/print  
the most current catalog sections.

Later updates supercede earlier updates.

(Revisions shown in **RED**)

# UPDATE HISTORY

## Valance – Attached Soffit Section



<b>JANUARY 2018</b>			
<b>MODEL #</b>	<b>TYPE OF UPDATE</b>	<b>DESCRIPTION OF UPDATE</b>	<b>CATALOG PAGE #</b>
14122	Dimension	Deleted 10D; added 21W, 24W, 18D	8
14123	Dimension	Deleted 10D; added 21W, 24W, 18D	8
14124	Dimension	Deleted 10D; added 21W, 24W, 18D	8
14125	Dimension	Deleted 10D; added 21W, 24W, 18D	8
14126	Dimension	Deleted 10D; added 27W, 30W, 33W, 42W, 45W, 48W, 18D	8
14127	Dimension	Deleted 10D; added 42W, 45W, 48W, 18D	8

<b>NOVEMBER 2017</b>			
<b>MODEL #</b>	<b>TYPE OF UPDATE</b>	<b>DESCRIPTION OF UPDATE</b>	<b>CATALOG PAGE #</b>
	Description	Changed "Height (H) denotes front face cabinet height" to "Height (H) denotes cabinet box height."	3-14
	Construction	Added "Valance Details" information	15

Table of Contents

**VALANCE – ATTACHED SOFFIT**

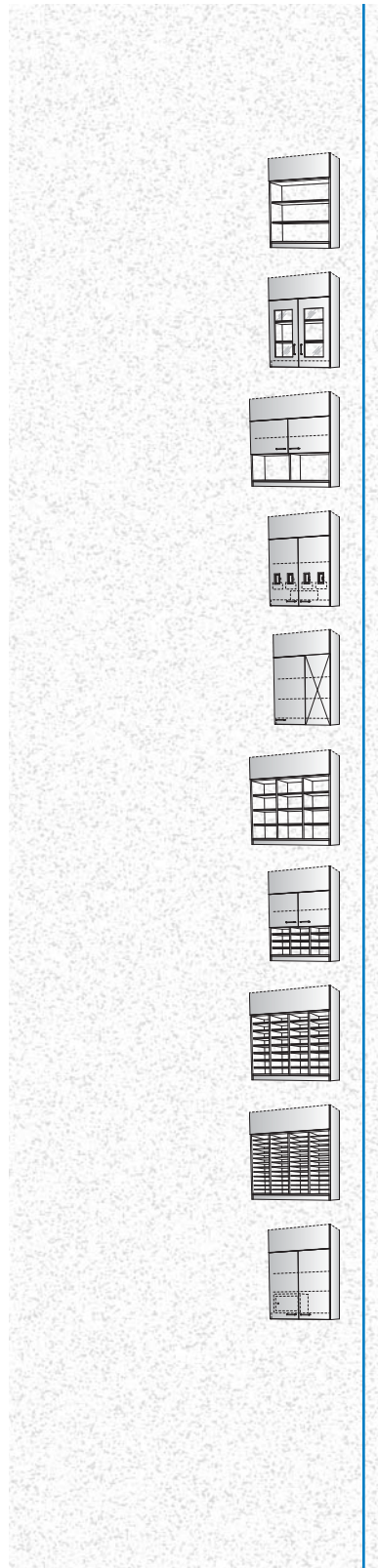

Shelf ..... 3-4

Display ..... 5-6

Bookshelf ..... 7

Dispensing ..... 8

Corner – Blind ..... 9

Cubicle ..... 10-11

Forms ..... 12

Mail Cubicle ..... 12

Folder ..... 13

Narcotics Locker ..... 14

**Valance Details ..... 15**

# VALANCE – ATTACHED SOFFIT

Commercial Cabinetry and Millwork





# VALANCE – ATTACHED SOFFIT

Shelf

Height (H) denotes cabinet box height.  
Soffits available 6"-18" high in 1" increments.

	W	H	D	W	H	D	W	H	D	W	H	D	W	H	D	W	H	D			
	12	18	14	12	18	14	12	25	14	12	18	14	12	25	14	24	18	14	24	25	14
	15	25	18	15	18	18	15	30	18	15	18	18	15	30	18	27	18	18	27	30	18
	18	30		18			18	36		18			18	36		30			30	36	
	21	36					21						21			33			33		
	24						24						24			36			36		
	27																			39	
	30																			42	
	33																			45	
	36																			48	
				Right Hinge Door			Right Hinge Door			Left Hinge Door			Left Hinge Door			Doors				Doors	
	<b>14101</b>			<b>14120</b>			<b>14120</b>			<b>14121</b>			<b>14121</b>			<b>14129</b>			<b>14129</b>		
																					<b>18H</b>
																					<b>25H</b> <b>30H</b> Adjustable Shelf
																					<b>36H</b> Adjustable Shelves

# VALANCE – ATTACHED SOFFIT

## Shelf

Height (H) denotes cabinet box height.

Soffits available 6"-18" high in 1" increments.



W	H	D
39	18	14
42	25	18
45	30	
48	36	

Center Divider

W	H	D
39	25	14
42	30	18
45	36	
48		

Doors  
Center Divider

W	H	D
36	18	14
39	25	18
42	30	
45	36	
48		

Sliding Doors  
Center Divider

### Microwave

W	H	D
27	36	14
30		18
33		
36		

Microwave Cabinet  
20"-Deep Attachable  
Microwave Shelf  
Accommodates Typical  
1 cu.ft. - 2 cu.ft. Microwave

14138

14181

14150

14149

18H

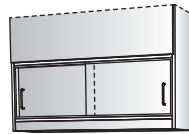
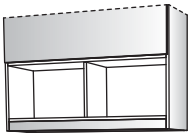

25H

30H

Adjustable  
Shelves

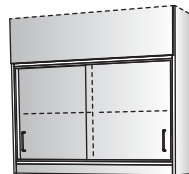
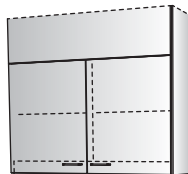
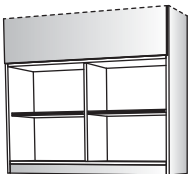

36H

Adjustable  
Shelves

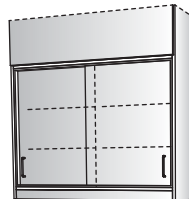

36H

16 1/16"

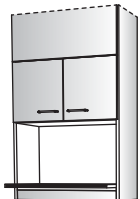



# VALANCE – ATTACHED SOFFIT

## Display

Height (H) denotes cabinet box height.  
Soffits available 6"-18" high in 1" increments.

W	H	D
15	25	14
18	30	18
21	36	
24		

Right Hinge  
Display Door

**14130**

W	H	D
15	25	14
18	30	18
21	36	
24		

Left Hinge  
Display Door

**14131**

W	H	D
30	25	14
36	30	18
	36	

Display Doors

**14136**

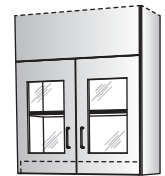

**25H**  
**30H**  
Adjustable  
Shelf

**36H**  
Adjustable  
Shelves

# VALANCE – ATTACHED SOFFIT



## Display

Height (H) denotes cabinet box height.

Soffits available 6"-18" high in 1" increments.

W	H	D
30	25	14
36	30	18
42	36	
48		

Sliding Display Doors  
Center Divider

W	H	D
30	18	14
33	25	18
36	30	
	36	

Sliding Glass Doors

W	H	D
39	18	14
42	25	18
45	30	
48	36	

Sliding Glass Doors  
Center Divider

W	H	D
30	25	14
36	30	18
42	36	
48		

Display Doors  
Center Divider

**14154**

**14156**

**14158**

**14182**

**18H**

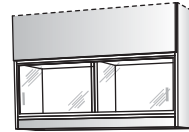
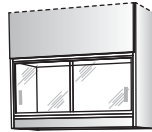

**25H**  
**30H**  
Adjustable  
Shelves

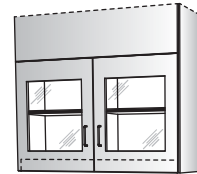
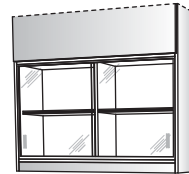
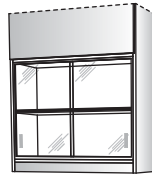
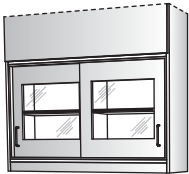

**36H**  
Adjustable  
Shelves

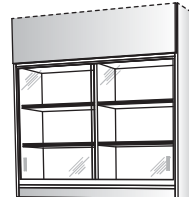
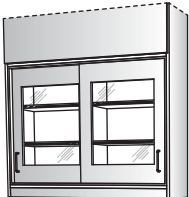



## Bookshelf

Height (H) denotes cabinet box height.  
Soffits available 6"-18" high in 1" increments.

W	H	D
12	30	14
15	36	18
18		
21		
24		

Right Hinge Door

W	H	D
12	30	14
15	36	18
18		
21		
24		

Left Hinge Door

W	H	D
30	30	14
33	36	18
36		

Doors

W	H	D
39	36	14
42		18
45		
48		

Doors  
Center Divider in  
Open Compartment

**14184**

**14185**

**14186**

**14187**

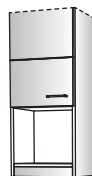
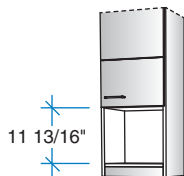

**30H**  
Open Compt.  
11<sup>13</sup>/<sub>16</sub>"H

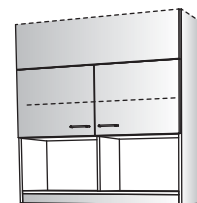
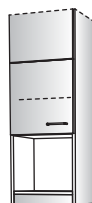
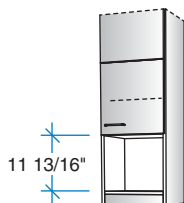

**36H**  
Open Compt.  
11<sup>13</sup>/<sub>16</sub>"H  
Adjustable  
Shelf

# VALANCE – ATTACHED SOFFIT



## Dispensing

Height (H) denotes cabinet box height.

Soffits available 6"-18" high in 1" increments.

Towel/Cup			Towel/Cup			Towel/Cup		
W	H	D	W	H	D	W	H	D
18	25	<del>14</del>	18	25	<del>14</del>	27	25	<del>14</del>
21	30	14	21	30	14	30	30	14
24	36	18	24	36	18	33	36	18
						36		
						39		
						42		
						45		
						48		
Right Hinge Door Towel/Cup Dispenser	Left Hinge Door Towel/Cup Dispenser		Doors Towel/Cup Dispenser					
<b>14122</b>	<b>14123</b>		<b>14126</b>					

Towel/Cup/Glove/Tissue			Towel/Cup/Glove/Tissue			Towel/Cup/Glove/Tissue		
W	H	D	W	H	D	W	H	D
18	25	<del>14</del>	18	25	<del>14</del>	36	25	<del>14</del>
21	30	14	21	30	14	39	30	14
24	36	18	24	36	18	42	36	18
						45		
						48		
Right Hinge Door Towel/Cup and Glove/Tissue Dispensers	Left Hinge Door Towel/Cup and Glove/Tissue Dispensers		Doors Towel/Cup and Glove/Tissue Dispensers					
<b>14124</b>	<b>14125</b>		<b>14127</b>					

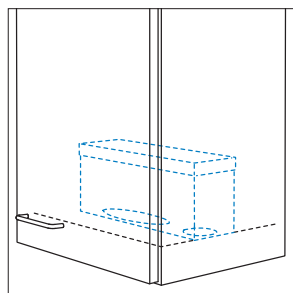
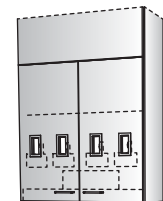
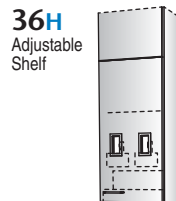
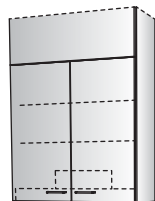
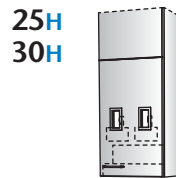
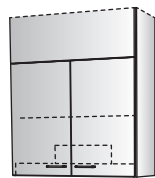

**TOWEL/CUP DISPENSER**  
Bottom-access dispensing of paper towels and 5 oz. cups.

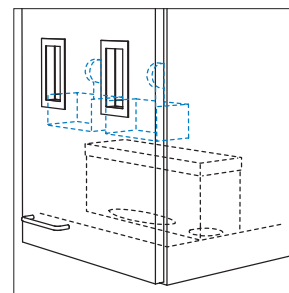

**GLOVE/TISSUE DISPENSER**  
Face-of-door access for gloves or tissues.

## Corner – Blind

Height (H) denotes cabinet box height.  
Soffits available 6"-18" high in 1" increments.

W	H	D
33	18	14
36	25	
	30	
	36	

36	18	18
39	25	
	30	
	36	

Left Hand Open

W	H	D
33	18	14
36	25	
	30	
	36	

36	18	18
39	25	
	30	
	36	

Right Hand Open

W	H	D
33	18	14
36	25	
	30	
	36	

36	18	18
39	25	
	30	
	36	

Right Hinge Door

W	H	D
33	18	14
36	25	
	30	
	36	

36	18	18
39	25	
	30	
	36	

Left Hinge Door

W	H	D
33	25	14
36	30	
	36	

36	25	18
39	30	
	36	

Right Hinge Display Door

W	H	D
33	25	14
36	30	
	36	

36	25	18
39	30	
	36	

Left Hinge Display Door

**14198**

**14199**

**14200**

**14201**

**14202**

**14203**

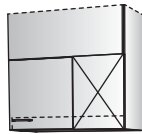
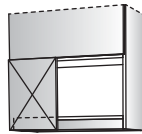
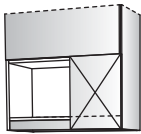

**18H**

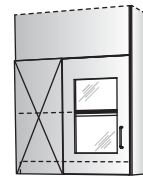
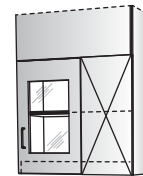
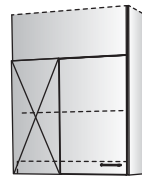
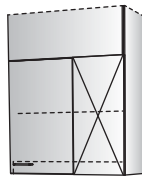
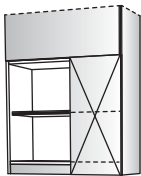

**25H**  
**30H**  
Adjustable Shelf

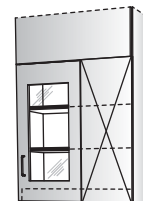
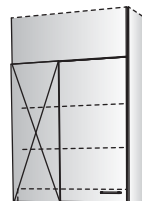
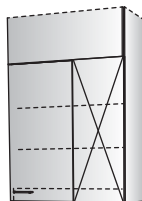
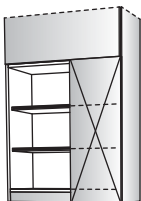

**36H**  
Adjustable Shelves

# VALANCE – ATTACHED SOFFIT



## Cubicle

Height (H) denotes cabinet box height.

Soffits available 6"-18" high in 1" increments.

Compt. Widths	W	H	D	W	H	D	W	H	D
7 7/8"	18	25	14	18	25	14	18	25	14
9 3/8"	21	30	18	21	30	18	21	30	18
10 7/8"	24	36		24	36		24	36	

3/4" Adjustable Cubicle Shelves

Right Hinge Door  
3/4" Adjustable Cubicle Shelves

Left Hinge Door  
3/4" Adjustable Cubicle Shelves

Compt. Widths	W	H	D	W	H	D
9"	30	25	14	30	25	14
11"	36	30	18	36	30	18
13"	42	36		42	36	
15"	48			48		

3/4" Adjustable Cubicle Shelves

Doors  
3/4" Adjustable Cubicle Shelves

14220

14222

14223

14226

14227

**25H**  
6 Compts.  
5 1/2"H



**30H**  
6 Compts.  
8"H

**25H**  
9 Compts.  
5 1/2"H

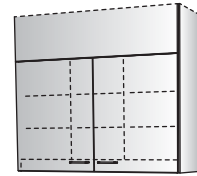
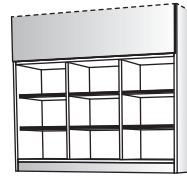

**30H**  
9 Compts.  
8"H

**36H**  
8 Compts.  
6 3/4"H



**36H**  
12 Compts.  
6 3/4"H





# WALL – ATTACHED SOFFIT

## Cubicle

Height (H) denotes cabinet box height.  
Soffits available 6"-18" high in 1" increments.

Compt. Widths	W	H	D
8"	36	25	14
9 1/2"	42	30	18
11"	48	36	

3/4" Adjustable  
Cubicle Shelves

W	H	D
36	25	14
42	30	18
48	36	

Doors  
3/4" Adjustable  
Cubicle Shelves

14239

14240

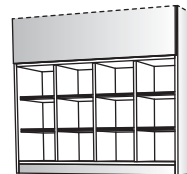

**25H**  
12 Compts.  
5 1/2"H

**30H**  
12 Compts.  
8"H

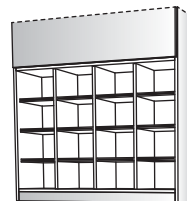

**36H**  
16 Compts.  
6 3/4"H

# VALANCE – ATTACHED SOFFIT



## Forms/Mail Cubicle – Open One Face

Minimum 3" compartment height.

Height (H) denotes cabinet box height.

Soffits available 6"-18" high in 1" increments.

### Forms

Compt. Widths	W	H	D
9"	30	30	14
11"	36	36	18
13"	42		
15"	48		

Upper Doors  
3/4" Adjustable, Equally  
Spaced Cubicle Shelves

### 14256

**30H**  
12 Compts.  
3"H minimum



**36H**  
12 Compts.  
3"H minimum  
Adjustable  
Shelf



### Mail Cubicle – Open One Face

Compt. Widths	W	H	D
9 3/8"	21	25	14
10 7/8"	24	30	18
13 7/8"	30	36	
16 7/8"	36		

Open One Face  
3/4" Adjustable, Equally  
Spaced Cubicle Shelves

### 14250

**25H**  
10 Compts.  
3"H minimum



**30H**  
14 Compts.  
3"H minimum



**36H**  
16 Compts.  
3"H minimum



Compt. Widths	W	H	D
9"	30	25	14
11"	36	30	18
13"	42	36	
15"	48		

Open One Face  
3/4" Adjustable, Equally  
Spaced Cubicle Shelves

### 14251

**25H**  
15 Compts.  
3"H minimum

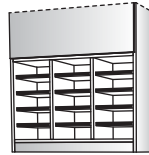

**30H**  
21 Compts.  
3"H minimum



**36H**  
24 Compts.  
3"H minimum



Compt. Widths	W	H	D
9 1/2"	42	25	14
11"	48	30	18
		36	

Open One Face  
3/4" Adjustable, Equally  
Spaced Cubicle Shelves

### 14252

**25H**  
20 Compts.  
3"H minimum

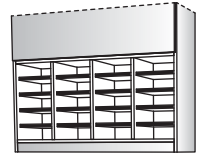

**30H**  
28 Compts.  
3"H minimum

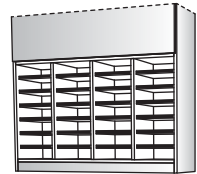







**36H**  
32 Compts.  
3"H minimum

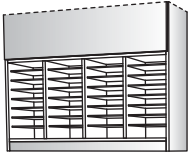

## Folder

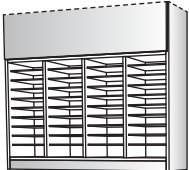
Minimum 2¼" compartment height.  
Height (H) denotes cabinet box height.  
Soffits available 6"-18" high in 1" increments.

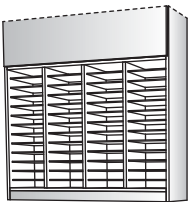
			Folder					
W	H	D	W	H	D	W	H	D
21	25	14	30	25	14	42	25	14
24	30	18	36	30	18	48	30	18
30	36		42	36			36	
36			48					
¼" Folder Shelves, Adjustable and Removable on 1¼" Centers			¼" Folder Shelves, Adjustable and Removable on 1¼" Centers			¼" Folder Shelves, Adjustable and Removable on 1¼" Centers		
14241			14242			14243		
 <p><b>25H</b> 16 Compts. 2¼"H minimum</p>			 <p><b>25H</b> 24 Compts. 2¼"H minimum</p>			 <p><b>25H</b> 32 Compts. 2¼"H minimum</p>		
 <p><b>30H</b> 20 Compts. 2¼"H minimum</p>			 <p><b>30H</b> 30 Compts. 2¼"H minimum</p>			 <p><b>30H</b> 40 Compts. 2¼"H minimum</p>		
 <p><b>36H</b> 26 Compts. 2¼"H minimum</p>			 <p><b>36H</b> 39 Compts. 2¼"H minimum</p>			 <p><b>36H</b> 52 Compts. 2¼"H minimum</p>		

# VALANCE – ATTACHED SOFFIT



## Narcotics Locker

The narcotics locker and cabinet door locks are keyed differently and require separate keys. Both doors to be keyed differently from all other cabinets.

Height (H) denotes cabinet box height.

Soffits available 6"-18" high in 1" increments.

W	H	D	W	H	D	W	H	D
15	25	14	15	25	14	30	25	14
18	30	18	18	30	18	36	30	18
21	36		21	36		39	36	
24			24			42		
						45		
						48		
Lockable Right Hinge Door Lockable Steel Narcotics Locker			Lockable Left Hinge Door Lockable Steel Narcotics Locker			Lockable Doors Lockable Steel Narcotics Locker		
<b>14290</b>			<b>14291</b>			<b>14294</b>		

**25H**  
**30H**  
Fixed Shelf

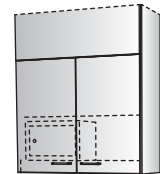

**36H**  
Fixed Shelf  
Adjustable Shelf

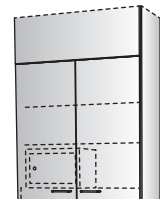



Stevens Advantage valance units are designed to allow continuous valance aprons under wall units. A finished end/drop left or drop right indication lowers the designated end panel to align with the valance rail. Field cutting of intermediate sides is not required to install under-cabinet valance lighting. Return corners are not required upon installation.

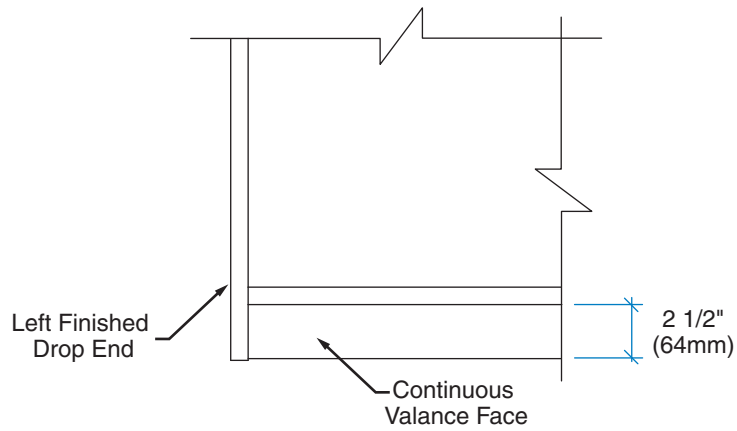

**LEFT FRONT CORNER**

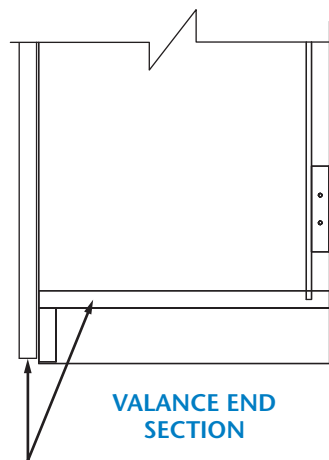

Because cabinet bottom is set up in relation to door bottom edge, exposed hinges will not align with conventional cabinet hinge locations.