

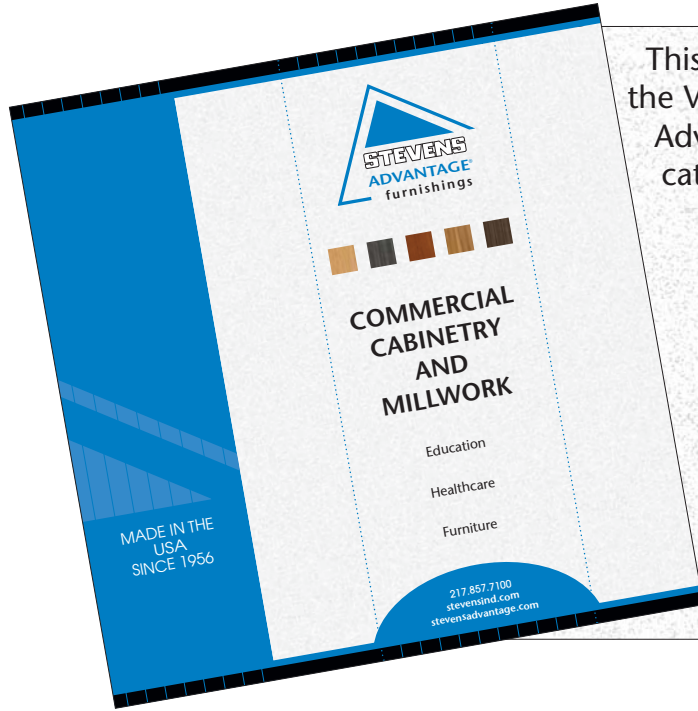

UPDATE HISTORY

Valance – Attached Soffit Section



This UPDATE HISTORY outlines changes made to the Valance – Attached Soffit section of the Stevens Advantage Commercial Cabinetry and Millwork catalog since it was published in August 2017.

The most recent updates are shown first.

Go to stevensadvantage.com

→ RESOURCES

→ Commercial Casework

to view/download/print
the most current catalog sections.

Later updates supercede earlier updates.

(Revisions shown in **RED**)

UPDATE HISTORY

Valance – Attached Soffit Section



MARCH 2018			
MODEL #	TYPE OF UPDATE	DESCRIPTION OF UPDATE	CATALOG PAGE #
14290	Dimension	Deleted 15W	14
14291	Dimension	Deleted 15W	14

JANUARY 2018			
MODEL #	TYPE OF UPDATE	DESCRIPTION OF UPDATE	CATALOG PAGE #
14122	Dimension	Deleted 10D; added 21W, 24W, 18D	8
14123	Dimension	Deleted 10D; added 21W, 24W, 18D	8
14124	Dimension	Deleted 10D; added 21W, 24W, 18D	8
14125	Dimension	Deleted 10D; added 21W, 24W, 18D	8
14126	Dimension	Deleted 10D; added 27W, 30W, 33W, 42W, 45W, 48W, 18D	8
14127	Dimension	Deleted 10D; added 42W, 45W, 48W, 18D	8

NOVEMBER 2017			
MODEL #	TYPE OF UPDATE	DESCRIPTION OF UPDATE	CATALOG PAGE #
	Description	Changed "Height (H) denotes front face cabinet height" to "Height (H) denotes cabinet box height."	3-14
	Construction	Added "Valance Details" information	15

Table of Contents

VALANCE – ATTACHED SOFFIT

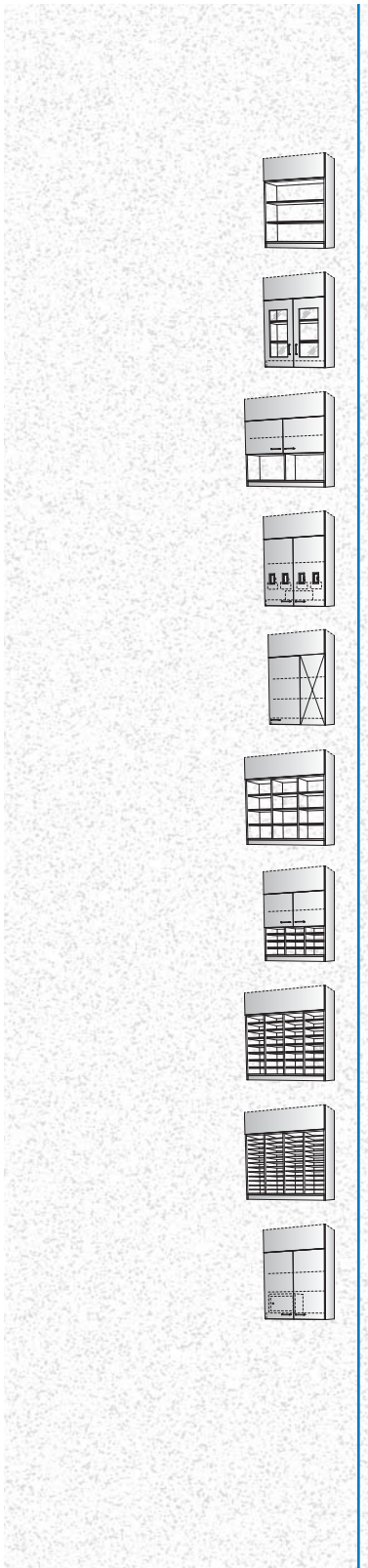

Shelf 3-4

Display 5-6

Bookshelf 7

Dispensing 8

Corner – Blind 9

Cubicle 10-11

Forms 12

Mail Cubicle 12

Folder 13

Narcotics Locker 14

Valance Details 15

VALANCE – ATTACHED SOFFIT

Commercial Cabinetry and Millwork





VALANCE – ATTACHED SOFFIT

Shelf

Height (H) denotes cabinet box height.
Soffits available 6"-18" high in 1" increments.

	W	H	D	W	H	D	W	H	D	W	H	D	W	H	D	W	H	D			
	12	18	14	12	18	14	12	25	14	12	18	14	12	25	14	24	18	14	24	25	14
	15	25	18	15		18	15	30	18	15		18	15	30	18	27		18	27	30	18
	18	30		18			18	36		18			18	36		30			30	36	
	21	36					21						21			33			33		
	24						24						24			36			36		
	27																			39	
	30																			42	
	33																			45	
	36																			48	
				Right Hinge Door			Right Hinge Door			Left Hinge Door			Left Hinge Door			Doors				Doors	
	14101			14120			14120			14121			14121			14129			14129		
Soffit Height Varies																					
Cabinet Box Height																					
																					18H
Soffit Height Varies																					
Cabinet Box Height																					
																					25H 30H Adjustable Shelf
Soffit Height Varies																					
Cabinet Box Height																					
																					36H Adjustable Shelves

VALANCE – ATTACHED SOFFIT

Shelf

Height (H) denotes cabinet box height.

Soffits available 6"-18" high in 1" increments.



W	H	D
39	18	14
42	25	18
45	30	
48	36	

Center Divider

W	H	D
39	25	14
42	30	18
45	36	
48		

Doors
Center Divider

W	H	D
36	18	14
39	25	18
42	30	
45	36	
48		

Sliding Doors
Center Divider

Microwave

W	H	D
27	36	14
30		18
33		
36		

Microwave Cabinet
20"-Deep Attachable
Microwave Shelf
Accommodates Typical
1 cu.ft. - 2 cu.ft. Microwave

14138

14181

14150

14149

18H

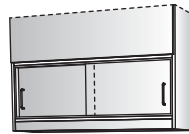
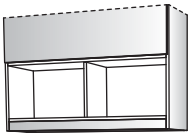

25H

30H

Adjustable
Shelves

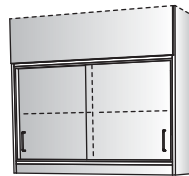
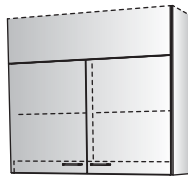
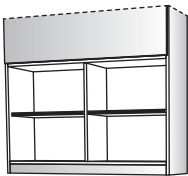

36H

Adjustable
Shelves

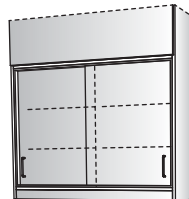

36H

16 1/16"

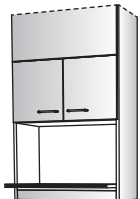



VALANCE – ATTACHED SOFFIT

Display

Height (H) denotes cabinet box height.
Soffits available 6"-18" high in 1" increments.

W	H	D
15	25	14
18	30	18
21	36	
24		

Right Hinge
Display Door

14130

W	H	D
15	25	14
18	30	18
21	36	
24		

Left Hinge
Display Door

14131

W	H	D
30	25	14
36	30	18
	36	

Display Doors

14136



25H
30H
Adjustable
Shelf

36H
Adjustable
Shelves

VALANCE – ATTACHED SOFFIT



Display

Height (H) denotes cabinet box height.

Soffits available 6"-18" high in 1" increments.

W	H	D
30	25	14
36	30	18
42	36	
48		

Sliding Display Doors
Center Divider

W	H	D
30	18	14
33	25	18
36	30	
	36	

Sliding Glass Doors

W	H	D
39	18	14
42	25	18
45	30	
48	36	

Sliding Glass Doors
Center Divider

W	H	D
30	25	14
36	30	18
42	36	
48		

Display Doors
Center Divider

14154

14156

14158

14182

18H

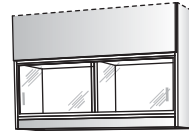
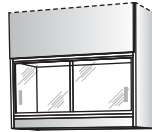

25H
30H
Adjustable
Shelves

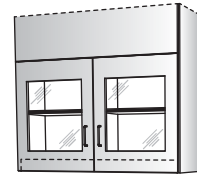
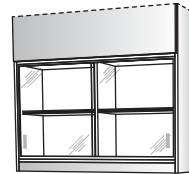
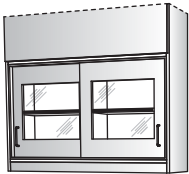

36H
Adjustable
Shelves

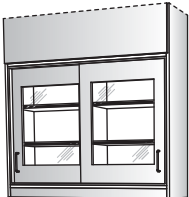

Bookshelf

Height (H) denotes cabinet box height.
Soffits available 6"-18" high in 1" increments.

W	H	D
12	30	14
15	36	18
18		
21		
24		

Right Hinge Door

W	H	D
12	30	14
15	36	18
18		
21		
24		

Left Hinge Door

W	H	D
30	30	14
33	36	18
36		

Doors

W	H	D
39	36	14
42		18
45		
48		

Doors
Center Divider in
Open Compartment

14184

14185

14186

14187

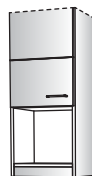
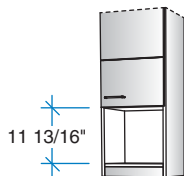

30H
Open Compt.
11¹³/₁₆"H

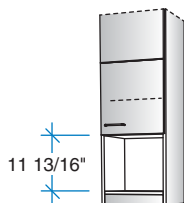

36H
Open Compt.
11¹³/₁₆"H
Adjustable
Shelf

VALANCE – ATTACHED SOFFIT



Dispensing

Height (H) denotes cabinet box height.
Soffits available 6"-18" high in 1" increments.

Towel/Cup								
W	H	D	W	H	D	W	H	D
18	25	14	18	25	14	27	25	14
21	30	14	21	30	14	30	30	14
24	36	18	24	36	18	33	36	18
						36		
						39		
						42		
						45		
						48		
Right Hinge Door Towel/Cup Dispenser	Left Hinge Door Towel/Cup Dispenser	Doors Towel/Cup Dispenser						
14122	14123	14126						

Towel/Cup/Glove/Tissue								
W	H	D	W	H	D	W	H	D
18	25	14	18	25	14	36	25	14
21	30	14	21	30	14	39	30	14
24	36	18	24	36	18	42	36	18
						45		
						48		
Right Hinge Door Towel/Cup and Glove/Tissue Dispensers	Left Hinge Door Towel/Cup and Glove/Tissue Dispensers	Doors Towel/Cup and Glove/Tissue Dispensers						
14124	14125	14127						

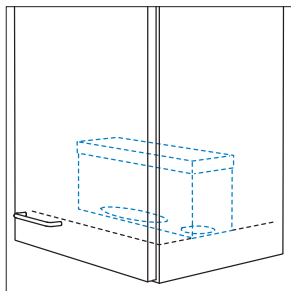

TOWEL/CUP DISPENSER
Bottom-access dispensing of paper towels and 5 oz. cups.

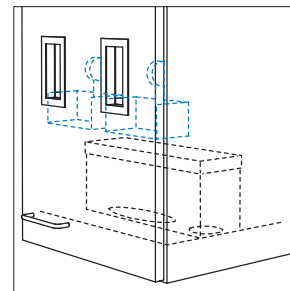

GLOVE/TISSUE DISPENSER
Face-of-door access for gloves or tissues.

Corner – Blind

Height (H) denotes cabinet box height.
Soffits available 6"-18" high in 1" increments.

W	H	D
33	18	14
36	25	
	30	
	36	

36	18	18
39	25	
	30	
	36	

Left Hand Open

W	H	D
33	18	14
36	25	
	30	
	36	

36	18	18
39	25	
	30	
	36	

Right Hand Open

W	H	D
33	18	14
36	25	
	30	
	36	

36	18	18
39	25	
	30	
	36	

Right Hinge Door

W	H	D
33	18	14
36	25	
	30	
	36	

36	18	18
39	25	
	30	
	36	

Left Hinge Door

W	H	D
33	25	14
36	30	
	36	

36	25	18
39	30	
	36	

Right Hinge Display Door

W	H	D
33	25	14
36	30	
	36	

36	25	18
39	30	
	36	

Left Hinge Display Door

14198

14199

14200

14201

14202

14203

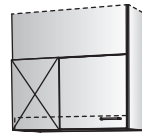
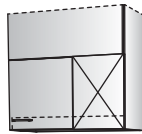
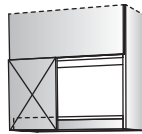
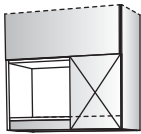

18H

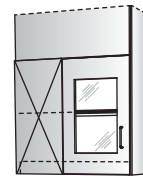
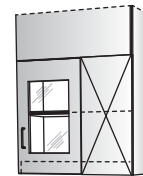
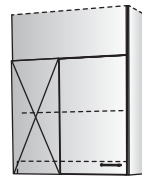
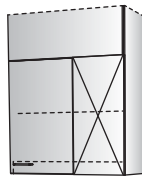
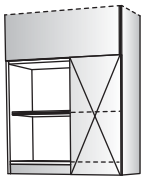

25H
30H
Adjustable Shelf

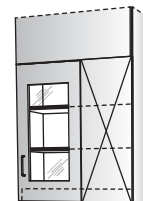
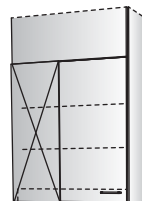
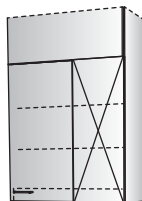
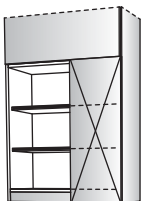

36H
Adjustable Shelves

VALANCE – ATTACHED SOFFIT



Cubicle

Height (H) denotes cabinet box height.

Soffits available 6"-18" high in 1" increments.

Compt. Widths	W	H	D	W	H	D	W	H	D
7 7/8"	18	25	14	18	25	14	18	25	14
9 3/8"	21	30	18	21	30	18	21	30	18
10 7/8"	24	36		24	36		24	36	

3/4" Adjustable Cubicle Shelves

Right Hinge Door
3/4" Adjustable Cubicle Shelves

Left Hinge Door
3/4" Adjustable Cubicle Shelves

Compt. Widths	W	H	D	W	H	D
9"	30	25	14	30	25	14
11"	36	30	18	36	30	18
13"	42	36		42	36	
15"	48			48		

3/4" Adjustable Cubicle Shelves

Doors
3/4" Adjustable Cubicle Shelves

14220

14222

14223

14226

14227

25H
6 Compts.
5 1/2"H



30H
6 Compts.
8"H

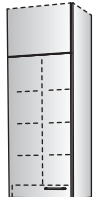

36H
8 Compts.
6 3/4"H

25H
9 Compts.
5 1/2"H

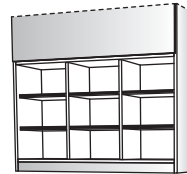

30H
9 Compts.
8"H

36H
12 Compts.
6 3/4"H





VALANCE – ATTACHED SOFFIT

Cubicle

Height (H) denotes cabinet box height.
Soffits available 6"-18" high in 1" increments.

Compt. Widths	W	H	D
8"	36	25	14
9 1/2"	42	30	18
11"	48	36	

3/4" Adjustable
Cubicle Shelves

W	H	D
36	25	14
42	30	18
48	36	

Doors
3/4" Adjustable
Cubicle Shelves

14239	14240
--------------	--------------

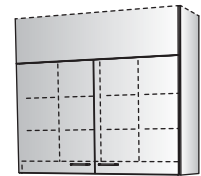
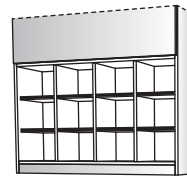

25H
12 Compts.
5 1/2"H

30H
12 Compts.
8"H

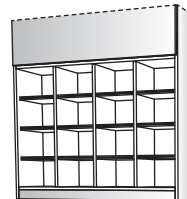

36H
16 Compts.
6 3/4"H

VALANCE – ATTACHED SOFFIT



Forms/Mail Cubicle – Open One Face

Minimum 3" compartment height.

Height (H) denotes cabinet box height.

Soffits available 6"-18" high in 1" increments.

Forms

Compt. Widths	W	H	D
9"	30	30	14
11"	36	36	18
13"	42		
15"	48		

Upper Doors
3/4" Adjustable, Equally Spaced Cubicle Shelves

14256

30H
12 Compts.
3"H minimum



36H
12 Compts.
3"H minimum
Adjustable Shelf



Mail Cubicle – Open One Face

Compt. Widths	W	H	D
9 3/8"	21	25	14
10 7/8"	24	30	18
13 7/8"	30	36	
16 7/8"	36		

Open One Face
3/4" Adjustable, Equally Spaced Cubicle Shelves

14250

25H
10 Compts.
3"H minimum



30H
14 Compts.
3"H minimum



36H
16 Compts.
3"H minimum



Compt. Widths	W	H	D
9"	30	25	14
11"	36	30	18
13"	42	36	
15"	48		

Open One Face
3/4" Adjustable, Equally Spaced Cubicle Shelves

14251

25H
15 Compts.
3"H minimum

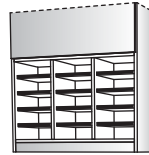

30H
21 Compts.
3"H minimum



36H
24 Compts.
3"H minimum



Compt. Widths	W	H	D
9 1/2"	42	25	14
11"	48	30	18
		36	

Open One Face
3/4" Adjustable, Equally Spaced Cubicle Shelves

14252

25H
20 Compts.
3"H minimum

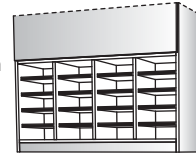

30H
28 Compts.
3"H minimum

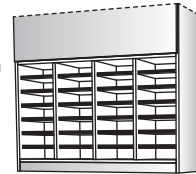







36H
32 Compts.
3"H minimum

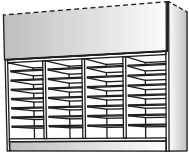

Folder

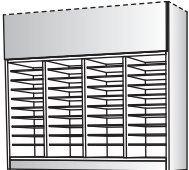
Minimum 2¼" compartment height.
Height (H) denotes cabinet box height.
Soffits available 6"-18" high in 1" increments.

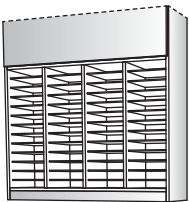
						Folder		
W	H	D	W	H	D	W	H	D
21	25	14	30	25	14	42	25	14
24	30	18	36	30	18	48	30	18
30	36		42	36			36	
36			48					
¼" Folder Shelves, Adjustable and Removable on 1¼" Centers			¼" Folder Shelves, Adjustable and Removable on 1¼" Centers			¼" Folder Shelves, Adjustable and Removable on 1¼" Centers		
14241			14242			14243		
								
25H 16 Compts. 2¼"H minimum			25H 24 Compts. 2¼"H minimum			25H 32 Compts. 2¼"H minimum		
								
30H 20 Compts. 2¼"H minimum			30H 30 Compts. 2¼"H minimum			30H 40 Compts. 2¼"H minimum		
								
36H 26 Compts. 2¼"H minimum			36H 39 Compts. 2¼"H minimum			36H 52 Compts. 2¼"H minimum		

VALANCE – ATTACHED SOFFIT



Narcotics Locker

The narcotics locker and cabinet door locks are keyed differently and require separate keys. Both doors to be keyed differently from all other cabinets.

Height (H) denotes cabinet box height.

Soffits available 6"-18" high in 1" increments.

W	H	D
18	25	14
18	30	18
21	36	
24		

Lockable Right Hinge Door
Lockable Steel Narcotics Locker

W	H	D
18	25	14
18	30	18
21	36	
24		

Lockable Left Hinge Door
Lockable Steel Narcotics Locker

W	H	D
30	25	14
36	30	18
39	36	
42		
45		
48		

Lockable Doors
Lockable Steel Narcotics Locker

14290

14291

14294

25H
30H
Fixed Shelf

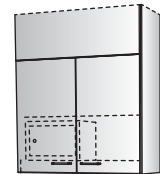

36H
Fixed Shelf
Adjustable Shelf

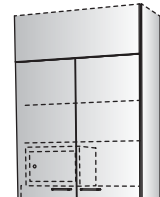

Stevens Advantage valance units are designed to allow continuous valance aprons under wall units. A finished end/drop left or drop right indication lowers the designated end panel to align with the valance rail. Field cutting of intermediate sides is not required to install under-cabinet valance lighting. Return corners are not required upon installation.

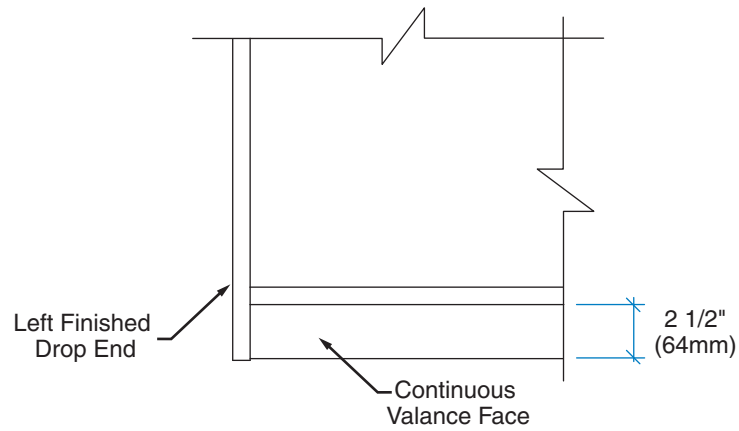

LEFT FRONT CORNER

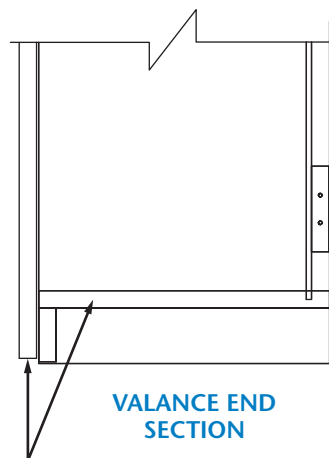

VALANCE END SECTION

Because cabinet bottom is set up in relation to door bottom edge, exposed hinges will not align with conventional cabinet hinge locations.